

Branch Tee (BT) Push-In Fitting Specifications:

Dimensions for Reference Use Only: Imperial fittings in Inch, Metric fittings in mm, U.S.O

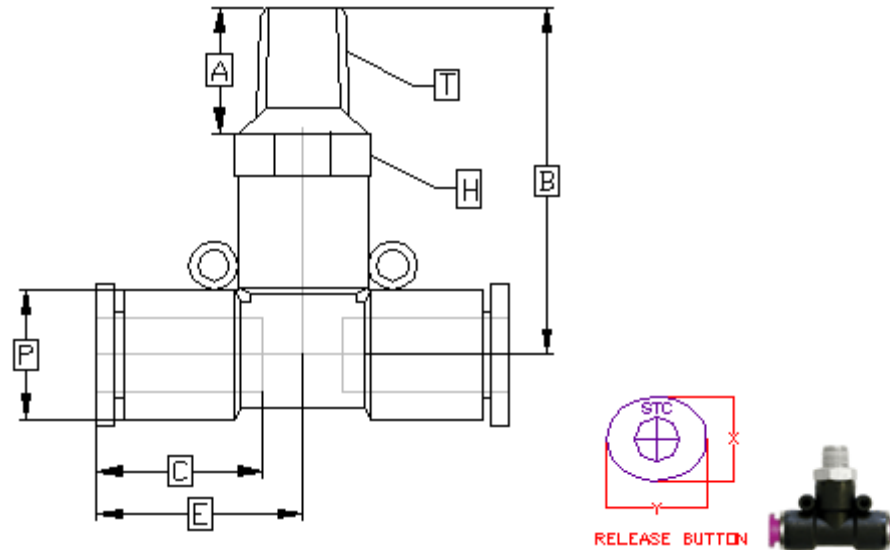

Branch Tee

| Part No. | Tube OD | T Pipe Size | A | B | C | D | E | H | P | T | D1 | X | Y | WEIGHT (g) |
|---------------|---------|----------------|------|------|------|------|------|-------|------|------|------|------|------|------------|
| BT 5/32 10-32 | 5/32 | 10-32UNF | 0.15 | 0.89 | 0.56 | 0.16 | 0.73 | 7/16 | 0.42 | 0.18 | 0.12 | 0.38 | 0.46 | 9.7 |
| BT 5/32 N1/8 | 5/32 | NPT1/8 | 0.32 | 1.02 | 0.56 | 0.16 | 0.70 | 7/16 | 0.42 | 0.39 | 0.12 | 0.38 | 0.46 | 11.4 |
| BT 5/32 N1/4 | 5/32 | NPT1/4 | 0.41 | 1.10 | 0.55 | 0.16 | 0.72 | 9/16 | 0.43 | 0.49 | 0.12 | 0.38 | 0.46 | 16.9 |
| BT 3/16 10-32 | 3/16 | 10-32UNF | 0.23 | 0.94 | 0.60 | 0.19 | 0.72 | 7/16 | 0.44 | 0.18 | 0.12 | 0.43 | 0.50 | 13.0 |
| BT 3/16 N1/8 | 3/16 | NPT1/8 | 0.31 | 1.01 | 0.62 | 0.19 | 0.73 | 7/16 | 0.44 | 0.40 | 0.12 | 0.43 | 0.50 | 12.7 |
| BT 3/16 N1/4 | 3/16 | NPT1/4 | 0.41 | 1.12 | 0.61 | 0.19 | 0.74 | 9/16 | 0.45 | 0.50 | 0.12 | 0.43 | 0.50 | 17.7 |
| BT 3/16 N3/8 | 3/16 | NPT3/8 | 0.41 | 1.12 | 0.61 | 0.19 | 0.75 | 11/16 | 0.44 | 0.49 | 0.12 | 0.43 | 0.50 | 17.7 |
| BT 1/4 10-32 | 1/4 | 10-32UNF | 0.14 | 0.99 | 0.64 | 0.26 | 0.84 | 1/2 | 0.53 | 0.18 | 0.12 | 0.45 | 0.53 | 14.6 |
| BT 1/4 N1/8 | 1/4 | NPT1/8 | 0.30 | 1.11 | 0.62 | 0.26 | 0.81 | 1/2 | 0.52 | 0.40 | 0.12 | 0.45 | 0.53 | 16.6 |
| BT 1/4 N1/4 | 1/4 | NPT1/4 | 0.43 | 1.24 | 0.60 | 0.26 | 0.83 | 9/16 | 0.52 | 0.51 | 0.12 | 0.45 | 0.53 | 20.4 |
| BT 1/4 N3/8 | 1/4 | NPT3/8 | 0.50 | 1.25 | 0.61 | 0.26 | 0.80 | 11/16 | 0.52 | 0.65 | 0.12 | 0.45 | 0.53 | 26.7 |
| BT 5/16 N1/8 | 5/16 | NPT1/8 | 0.33 | 1.18 | 0.67 | 0.32 | 0.91 | 9/16 | 0.58 | 0.40 | 0.12 | 0.54 | 0.61 | 20.8 |

| | | | | | | | | | | | | | | |
|--------------|---------|----------------|------|------|------|------|------|-------|------|------|------|------|------|------------|
| BT 5/16 N1/4 | 5/16 | NPT1/4 | 0.44 | 1.28 | 0.67 | 0.32 | 0.91 | 9/16 | 0.78 | 0.52 | 0.12 | 0.54 | 0.61 | 22.7 |
| BT 5/16 N3/8 | 5/16 | NPT3/8 | 0.49 | 0.37 | 0.67 | 0.32 | 0.91 | 11/16 | 0.57 | 0.65 | 0.12 | 0.54 | 0.61 | 30.3 |
| BT 3/8 N1/8 | 3/8 | NPT1/8 | 0.32 | 1.29 | 0.79 | 0.38 | 1.08 | 11/16 | 0.72 | 0.39 | 0.12 | 0.66 | 0.74 | 34.0 |
| BT 3/8 N1/4 | 3/8 | NPT1/4 | 0.44 | 1.44 | 0.81 | 0.38 | 1.09 | 11/16 | 0.72 | 0.51 | 0.12 | 0.66 | 0.74 | 36.5 |
| BT 3/8 N3/8 | 3/8 | NPT3/8 | 0.48 | 1.48 | 0.80 | 0.38 | 1.08 | 11/16 | 0.71 | 0.65 | 0.12 | 0.66 | 0.74 | 40.6 |
| BT 3/8 N1/2 | 3/8 | NPT1/2 | 0.56 | 1.55 | 1.09 | 0.38 | 1.08 | 7/8 | 0.72 | 0.80 | 0.12 | 0.66 | 0.74 | 49.7 |
| BT 1/2 N1/4 | 1/2 | NPT1/4 | 0.38 | 1.52 | 0.81 | 0.51 | 1.14 | 7/8 | 0.86 | 0.51 | 0.12 | 0.79 | 0.88 | 52.4 |
| BT 1/2 N3/8 | 1/2 | NPT3/8 | 0.49 | 1.59 | 0.80 | 0.50 | 1.17 | 7/8 | 0.85 | 0.65 | 0.12 | 0.79 | 0.88 | 55.0 |
| BT 1/2 N1/2 | 1/2 | NPT1/2 | 0.56 | 1.66 | 0.81 | 0.50 | 1.17 | 7/8 | 0.86 | 0.80 | 0.12 | 0.79 | 0.88 | 61.0 |
| | | | | | | | | | | | | | | |
| Part No. | Tube OD | T Pipe Size | A | B | C | D | E | H | P | T | D1 | X | Y | WEIGHT (g) |
| BT 4 M5 | 4 | M5 | 5.0 | 23.1 | 14.4 | 4.0 | 18.0 | 10 | 10.7 | 4.8 | 3.0 | 9.7 | 11.7 | 9.8 |
| BT 4 M6 | 4 | M6 | 7.7 | 24.7 | 14.5 | 4.1 | 18.4 | 10 | 70.8 | 5.9 | 3.0 | 9.7 | 11.7 | 10.6 |
| BT 4 R1/8 | 4 | R1/8 | 7.9 | 25.1 | 13.5 | 4.1 | 18.1 | 10 | 10.8 | 9.6 | 3.0 | 9.7 | 11.7 | 10.9 |
| BT 4 R1/4 | 4 | R1/4 | 9.2 | 26.5 | 13.9 | 4.1 | 18.1 | 14 | 10.9 | 13.1 | 3.0 | 9.7 | 11.7 | 15.1 |
| BT 6 M5 | 6 | M5 | 4.0 | 25.9 | 15.4 | 6.0 | 21.0 | 12 | 13.0 | 4.8 | 3.0 | 11.5 | 13.5 | 14.5 |
| BT 6 M6 | 6 | M6 | 5.6 | 25.8 | 15.8 | 6.2 | 20.7 | 12 | 13.4 | 5.7 | 3.0 | 11.5 | 13.5 | 15.7 |
| BT 6 R1/8 | 6 | R1/8 | 7.7 | 28.5 | 15.2 | 6.1 | 20.1 | 12 | 13.0 | 9.6 | 3.0 | 11.5 | 13.5 | 15.9 |
| BT 6 R1/4 | 6 | R1/4 | 9.1 | 29.4 | 15.9 | 6.1 | 21.1 | 14 | 13.1 | 12.8 | 3.0 | 11.5 | 13.5 | 19.0 |
| BT 6 R3/8 | 6 | R3/8 | 10.5 | 30.5 | 15.5 | 6.0 | 21.2 | 17 | 13.2 | 16.2 | 3.0 | 11.5 | 13.5 | 26.1 |
| BT 6 R1/2 | 6 | R1/2 | 0.5 | 33.9 | 15.2 | 6.1 | 20.7 | 21 | 13.2 | 20.6 | 3.0 | 11.5 | 13.5 | 39.5 |
| BT 8 R1/8 | 8 | R1/8 | 7.5 | 29.4 | 16.4 | 7.8 | 22.8 | 14 | 14.5 | 9.6 | 3.0 | 13.6 | 15.6 | 20.0 |
| BT 8 R1/4 | 8 | R1/4 | 9.1 | 30.2 | 16.7 | 8.1 | 23.3 | 14 | 14.6 | 12.5 | 3.0 | 13.6 | 15.6 | 21.1 |
| BT 8 R3/8 | 8 | R3/8 | 9.8 | 32.6 | 16.5 | 8.2 | 23.1 | 17 | 14.9 | 16.1 | 3.0 | 13.6 | 15.6 | 28.3 |
| BT 8 R1/2 | 8 | R1/2 | 12.3 | 34.6 | 16.6 | 8.2 | 22.9 | 21 | 14.5 | 20.5 | 3.0 | 13.6 | 15.6 | 40.8 |
| BT 10 R1/8 | 10 | R1/8 | 7.6 | 31.8 | 20.4 | 10.2 | 27.8 | 17 | 18.1 | 9.4 | 3.0 | 16.0 | 18.3 | 32.6 |
| BT 10 R1/4 | 10 | R1/4 | 8.8 | 34.3 | 19.6 | 10.1 | 27.1 | 17 | 18.2 | 12.8 | 3.0 | 16.0 | 18.3 | 34.4 |
| BT 10 R3/8 | 10 | R3/8 | 11.2 | 35.5 | 20.4 | 10.1 | 28.4 | 17 | 18.4 | 16.5 | 3.0 | 16.0 | 18.3 | 37.8 |
| BT 10 R1/2 | 10 | R1/2 | 12.5 | 38.4 | 27.9 | 10.2 | 27.4 | 21 | 18.2 | 20.6 | 3.0 | 16.0 | 18.3 | 49.0 |
| BT 12 R1/4 | 12 | R1/4 | 8.7 | 34.6 | 19.4 | 11.8 | 28.1 | 19 | 20.3 | 13.0 | 3.0 | 18.6 | 21.5 | 43.4 |
| BT 12 R3/8 | 12 | R3/8 | 10.9 | 36.4 | 19.6 | 12.0 | 28.5 | 19 | 20.2 | 16.3 | 3.0 | 18.6 | 21.5 | 46.4 |
| BT 12 R1/2 | 12 | R1/2 | 12.0 | 39.3 | 19.6 | 11.9 | 28.3 | 21 | 20.1 | 20.5 | 3.0 | 18.6 | 21.5 | 56.5 |

Specifications, Materials of Construction and Schematic of Typical Construction:

| | Composite Fittings | |
|-----------------------------|--|----------------------------|
| | (Standard-Purple Button) | (K Series-Black Button) |
| Operating Pressure Range | 0 - 150 PSI (0 - 990 kpa) | 0 - 180 PSI (0 - 1200 kpa) |
| Vacuum | 0 - 29.5 in Hg (750 mm Hg) | |
| Operating Temperature | 32 - 140 °F (0 - 60 °C) | |
| Recommended Tubing Material | Polyurethane, Nylon, Polyethylene, Polypropylene | |
| Metal Body | Brass, Nickel Plated | |
| Plastic Body | PBT (Polybutylene terephthalate) | |
| Release Button | POM (Poly oxy methylene copolymer) | |
| Grip Ring or Collet | 300 series Stainless Steel | |
| O-ring | NBR (Buna-N) | |
| Thread Sealant | Teflon | |
| Service | FOR AIR ONLY | |

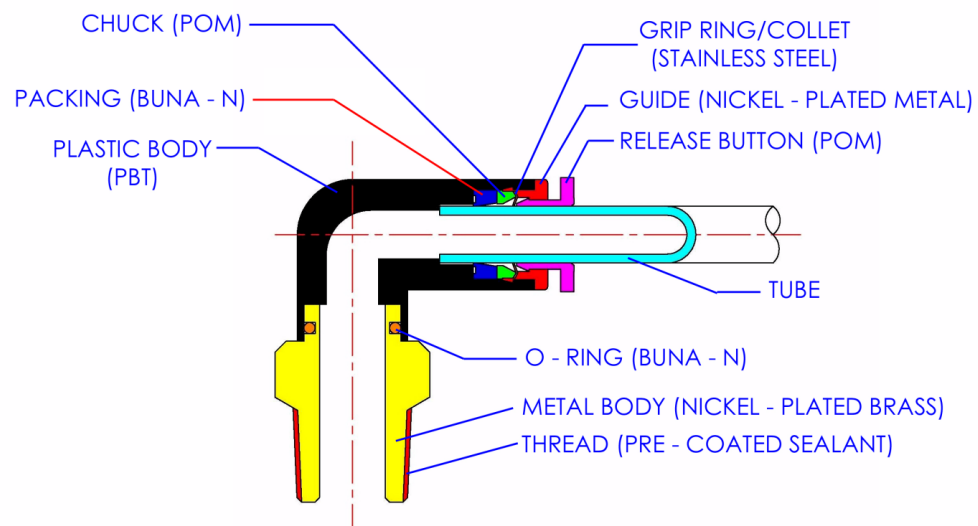

SCHMATIC OF TYPICAL COMPOSITE FITTING CONSTRUCTION